

GALSTON

ROAD

BM SSM 15741 RL196.322AHD

197
DP 752048

181
DP 752048
4.047ha

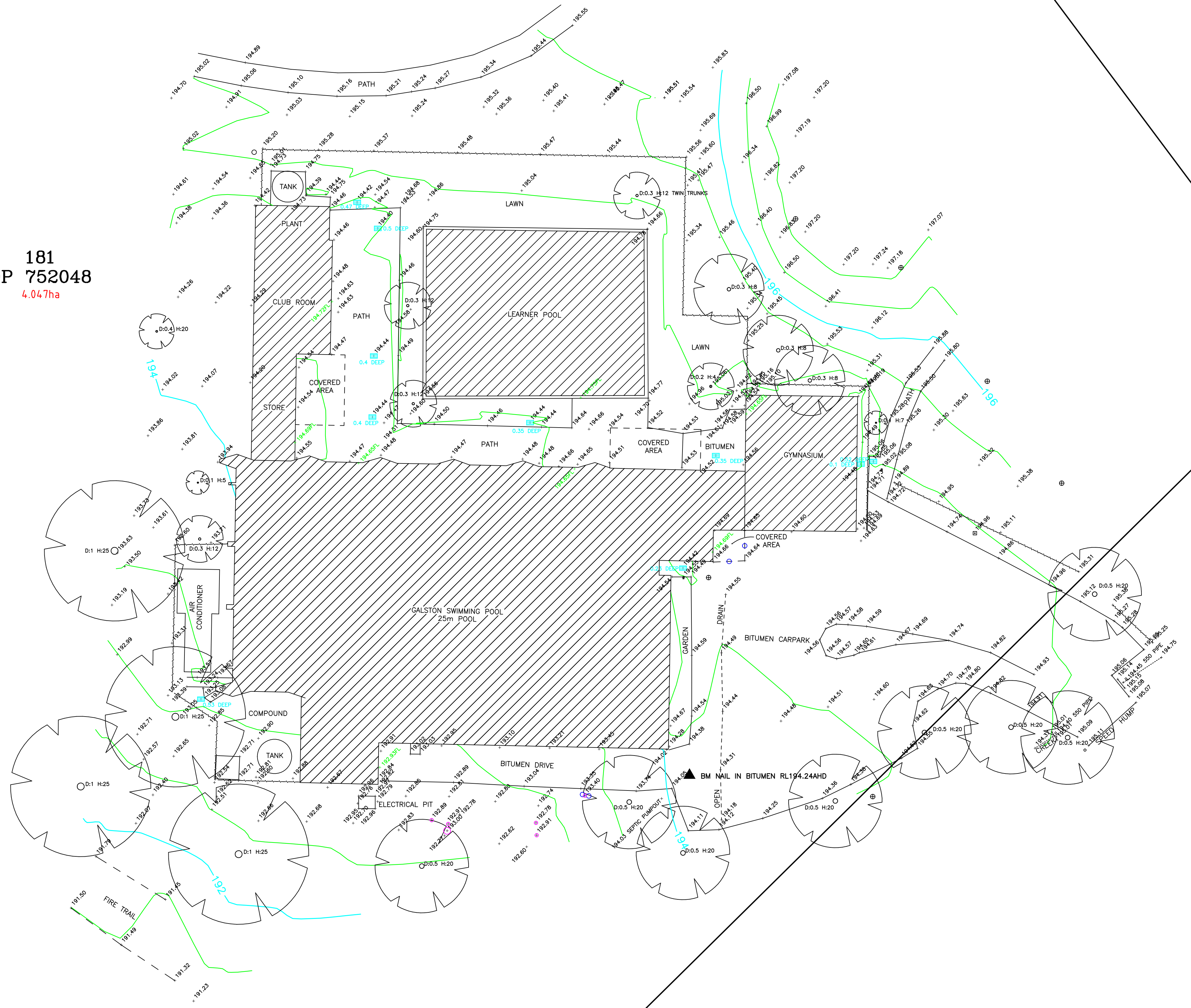

- LEGEND
- BOLLARD
 - HYDRANT
 - INSPECTION EYE
 - LIGHT
 - POWER POLE
 - SEWER
 - SIGN POST
 - STORMWATER PIT
 - TELSTRA PIT

AMENDMENTS:

1. THE BOUNDARIES HAVE BEEN LOCATED BY PLAN DIMENSIONS ONLY AND NOT BY FIELD MEASUREMENT.
2. SERVICES HAVE NOT BEEN LOCATED. PRIOR TO ANY EXCAVATION SERVICE DIAGRAMS SHOULD BE OBTAINED FROM THE RELEVANT AUTHORITIES.
3. SPOT LEVELS SHOULD BE ADOPTED IN PREFERENCE TO CONTOURS. CRITICAL LEVELS AND FEATURES MUST BE VERIFIED.
4. REFER TO TITLE FOR RESTRICTIONS IF ANY.
5. THIS PLAN IS ONLY TO BE USED FOR THE PURPOSE OF DESIGNING NEW CONSTRUCTIONS.

IREDALE & ASSOCIATES
LAND AND ENGINEERING SURVEYORS
34A CRANSTONS ROAD, MIDDLE
DURAL 2158 Ph : 9680 3999

A1 PLAN
LONGITUDINAL SECTION - HOR. 1:
- VERT. 1:
CROSS SECTION
CONTOUR INTERVAL 0.5 METRES
LEVELS ARE ON AUST. HEIGHT DATUM

ORIGIN OF LEVELS - SSM15741 RL 196.322 AHD
LOCATION AND DIMENSION OF TREES ARE APPROXIMATE ONLY
UNLESS SHOWN OTHERWISE THE TOP OF GUTTER HAS BEEN LOCATED
DIAL 1100 DIAL BEFORE YOU DIG BEFORE CONSTRUCTION COMMENCES

DETAIL SURVEY OF LOT 181 IN DP 752048
BEING GALSTON SWIMMING POOL 484
GALSTON ROAD, GALSTON
CLIENT : HORNSBY COUNCIL VIA ARCHITECTS OF ARCADIA
DATE : 14/06/19 PLAN NUMBER : 190602 - 1